

# somlock

## miniK 10

### INSTALLATION

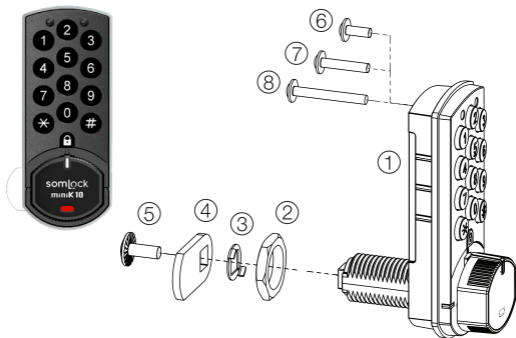

**electronic cabinet lock**

● cabinets ● boxes ● drawers

# Installation Overview

1. miniK10
2. M16x1,5mm Cylinder Nut
3. Stop Cam
4. Cam 38mm Axle
5. M4x8mm Cam Screw
- 6-8. Mounting Screws

Locking Position  
(Be sure before mounting).



Rotate Right  
(90°) to Open

Door thickness

Screw size

⑥ 0 - 5 mm doors	8 mm
⑦ 10 - 12 mm doors	16 mm
⑧ 16 - 18 mm doors	24 mm

Do not use longer screw.  
It may cause damage!

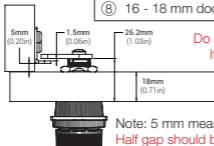

Note: 5 mm measurement is for 18 mm..!  
Half gap should be 1.50 mm

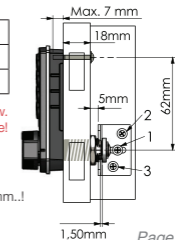

## Mounting on Left & Right Door

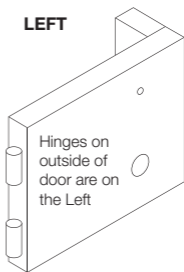
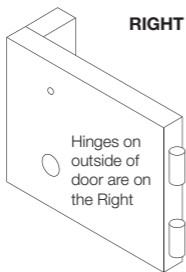

Peg on stop cam is on the right side for right doors

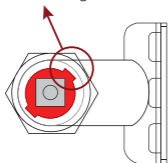

### **Back View**

Knob, rotates to the right to open lock

Peg on stop cam is on the left side for left doors

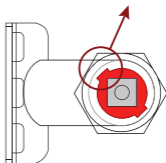

### **Back View**

Knob, rotates to the left to open lock



View of the lock in locked position

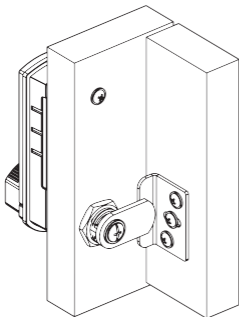

Surface Mounting

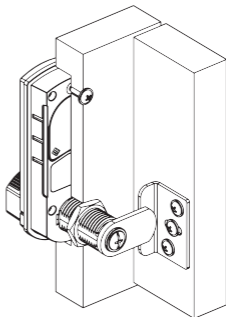

Semi-Flush Mounting

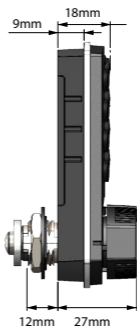
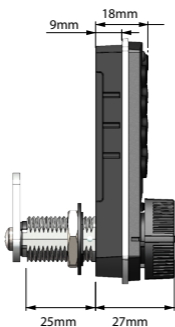
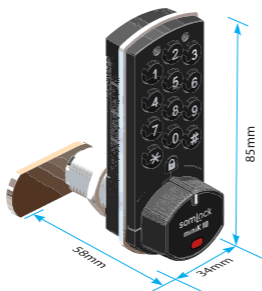

## Hole Template

Ø 4mm (0.16in)

Upper Mounting  
Screw Hole

miniK10 Outline

62mm (2.44in)



If the cylinder hole is pre-drilled and is larger than 16mm, it is necessary to use one of the adapter parts below according to the hole diameter for proper assembly and operation of the lock.

(Refer the Assembly Notes 3.3. in page 10)

### Adapter Washer

	(16mm - 19mm) <b>050 033 1162</b>
	(18mm - 22mm) <b>050 033 1163</b>

Ø 16mm (0.63in)

Cylinder Hole



## OVERLAPPING / EXTERNAL DOOR ASSEMBLY MEASUREMENTS

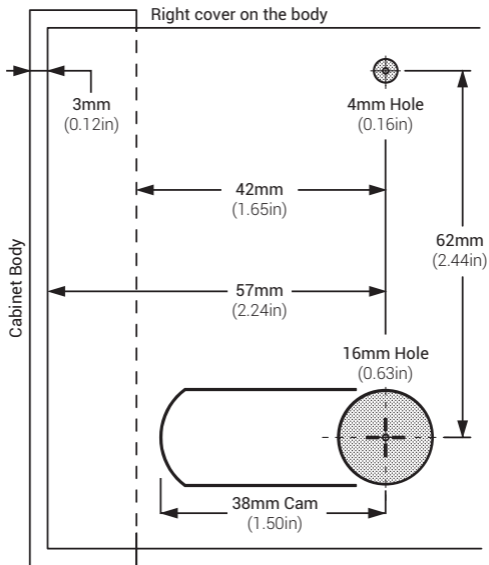

38 mm cam is recommended.

## Necessary Equipment for Assembly;

Drill (4mm, 8mm, 16mm), Spanner (19mm), Phillips Screwdriver, Pencil, Ruler.



**NOTE:** Read instructions, set combination and test lock BEFORE installing!

### Replacing existing lock:

1. Place mounting template centered on existing hole and mark upper mounting screw hole.
2. Drill mounting screw hole.
3. Install lock using adaptor if necessary.
4. Thread nut on cylinder.
5. Install mounting screw
6. Tighten both nut and mounting screw.
7. Test operation of lock

### New Install:

1. Place mounting template on door and mark upper mounting screw hole and lower cylinder hole
2. Drill mounting screw hole and cylinder holes.
3. Continue steps 4-7 above



**NOTE:** Before drilling holes, make sure miniK10 is positioned with proper clearance for cam to work.



If you are going to install the lock cam in the locked position, make sure that the handle is in the **locked position**.



**LOCKED  
POSITION**

If you are going to install the lock cam in the unlocked position, make sure that the handle is in the **unlocked position**.



**UNLOCKED  
POSITION**



For **5-Step Assembly**  
Video;



For More Information;  
**[somlock.com/en/support](https://somlock.com/en/support)**





## WARNINGS FOR ASSEMBLY:

1. Pull the transparent "Remove to Start" tag coming out of battery cap at the back of the lock and activate the lock.
2. Before mounting the lock;
  - 2.1. Make sure that the cabinet door is working properly, if not, make the door settings.
  - 2.2. Switch lock handle to closing position.
3. While drilling holes for mounting;
  - 3.1. Determine and mark the appropriate dimensions for the cabinet door.
  - 3.2. When marking, take into account the working gap of the door and the door strike.
  - 3.3. If it has been drilled before, check the hole size, if it is large, use the appropriate adapter. (Page 6)
4. While mounting;
  - 4.1. Make sure that you install the Right/ Left selector part (Stop Cam) in the correct direction according to the door direction.
  - 4.2. Do not over tighten the Mounting Screw and nut. Its maximum torque is **2 Nm**.
  - 4.3. Mount the door striker in such a way as to center the lock cam.
5. Test that the cabinet door is working properly by performing the unlocking and closing operations.
6. Depending on usage, door hinge settings may change during the year. Periodically check the door hinge settings. Tighten the loose screws on the lock and door.
7. Do not forget to change the Master password of the lock with your own.



Notes: .....

.....

.....

.....

.....

.....

.....

.....

.....

.....

.....

.....

.....

.....

.....



.....

.....

.....



- School / Dormitories
- Hospitals
- Offices
- Staff Lockers
- Rental Lockers
- Security / Defence Lockers
- Gym's / Spa's
- Malls / Stores
- In Home Life
- Hotels / Restaurants
- Mailboxes

 VMS Elektronik San. ve Tic. A.S.  
NOSAB Zeytin Cad.14 16220 Nilufer / BURSA / TÜRKİYE  
 + 90 (224) 411 10 30  
 + 90 (224) 411 10 31



MADE IN TÜRKİYE

somlock.com



somlock and miniK 10 VMS Elektronik San. ve Tic. A.S.'s trademark.



**For Contact**

vmselektronik.com

export@vmselektronik.com