

somlock

miniK 10mc

OPERATING MANUAL



electronic cabinet lock

● cabinets ● boxes ● drawers



Please read this
manual before using
the **miniK10mc**

INDEX

| | |
|---|----|
| Introduction..... | 3 |
| Description..... | 4 |
| Initial Setup..... | 4 |
| Assign Master Card..... | 4 |
| Locker Mode Operation with Card To Lock/Unlock..... | 4 |
| • To Lock..... | 4 |
| • To Unlock..... | 5 |
| General Warnings..... | 6 |
| Cam..... | 6 |
| Light and Audio Warnings..... | 7 |
| Technical Specifications..... | 7 |
| K10mc Compatible Card..... | 7 |
| Battery Replacement..... | 8 |
| To be Considered After Battery Replacement..... | 8 |
| Battery Failure Override..... | 8 |
| When Using The Lock..... | 8 |
| When Storage The Lock..... | 8 |
| Maintenance..... | 8 |
| Limited Warranty..... | 9 |
| Liability Limits..... | 9 |
| Quick Info..... | 11 |

INTRODUCTION

1. Red LED
2. Green LED
3. Wake-up Button
4. Lock Body
5. Closing Position
6. Knob Indicator
7. Opening Position
8. Knob
9. Mounting Screw
10. Lock Body
11. Battery Cover
12. Battery Cover Screw
13. ID Label
14. Hand Knob Frame
15. Cam
16. Cam Screw
17. Mounting Nut, R/L Stop Cam
18. Open/Closed Indicator
19. hopinlock[®], Card Compatibility indicator

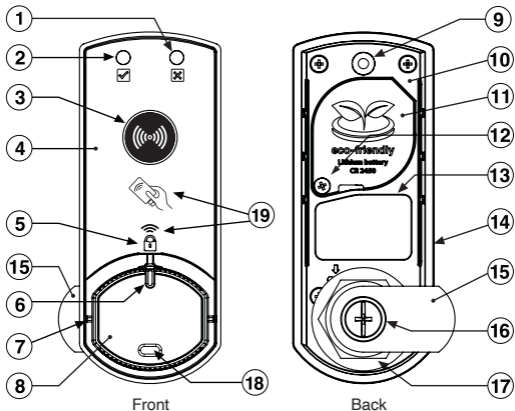

DESCRIPTION:

miniK10mc it is an electronic combination cabinet lock with features such as easy application on right/left cabinet doors, longer battery life with very low energy consumption, high reliability and working with contactless cards.

INITIAL SETUP:

• Assign Master card:

1- Press the button, beep is heard with green led flashing repeatedly.

2- And then present the **Master Card** to the lock until two tone beep is heard and green led blinks. *(You have to do this action in 4 seconds otherwise red led blinks and the lock sleeps.)*



1



2



This step is valid if there is no assigned Master Card before.

• Locker Mode Operation

• To Lock:

1- Press the button for wake the lock up. Only one beep is heard.

2- Present **User Card or Master Card** over the button.

(You have to do this action in 4 seconds otherwise red led blinks and the lock sleeps.)

3- Turn the knob to the locked position.

1



2



3



⚠ ATTENTION: When you lock the cabinet with a User Card other than Master Card, you can not close another cabinet with this user card. If you want to use this user card with another cabinet, first please open the closed cabinet with same User Card.

• **To Unlock:**

- 1- Press the button for wake the lock up. Only one beep is heard
- 2- Present **User Card or Master Card** over the button. *(You have to do this action in 4 seconds otherwise red led blinks and the lock sleeps.)*
- 3- Turn the knob to the unlocked position.



⚠ ATTENTION: If you open a locked cabinet with the Master Card, you cannot lock any other cabinet with the User Card that has locked this cabinet. To be able to use this card again, please close the cabinet with the Master Card first and then open the cabinet again with the User Card you locked.

If you want to use the miniK10mc lock with the hopinlock® Manager program for additional features (individual usage, setup locks, organize users, assign tasks etc.), You should download the hopinlock® Manager App by scanning the QR code below. *(You must have an NFC-enabled device to use the app.)*



hopinlock® Manager App



<https://t.ly/84vA>

GENERAL WARNINGS:

- Read manual before using lock.
- Periodically check nuts and screws to be tightened.
- Do not over-tighten nuts or screws. Do not use an electric screw gun during installation unless equipped with a torque adjuster. The maximum torque on the cylinder screw is 2Nm.
- Not possible for front side of lock to be opened by breaking or trying to force open lock.
- Use **CR2450** 3.0V Lithium batteries.
- The lock battery can be replaced with a CR 2450 battery with a min.600mA capacity.
- It should not be preferred that the production date of the new battery to be installed is more than 1 year.



CAM:

- Cam are included
- Cam can be placed at increments of 90 degrees
- The Stop Cam (#3) in installation instructions can be positioned for turning the cam clockwise or counter-clockwise

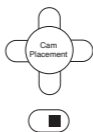

7/8" Straight Cam 38mm
(It is recommended)



LIGHT AND AUDIO WARNINGS:

| | |
|-------------------------|--|
| Card is accepted | Green LED blinks with audio warnings. |
| Wrong card | Red LED blinks with 4 repeated audio warnings. |

K10mc COMPATIBLE CARD:

MIFARE Classic®...

TECHNICAL SPECIFICATIONS:

| | |
|---------------------------|---|
| Dimension (WxHxD) | 34 x 85 x 27 mm (1.34 x 3.35 x 1.06in) |
| Weight | 70,4 g (2.48 oz) (excluding cam and mounting) |
| Key Pad | Silicone button with metal dome |
| Operating Temperature (*) | +10 / +50 °C (50 - 122 °F) |
| Storage Temperature | +0 / +30 °C (32 - 86 °F) |
| Relative Humidity | 20% - 80% Rh (non-condensing) |
| Replaceable Battery | 3V Lithium CR2450 |
| Battery Life (**) | Up to 2 years with daily 10 opening |

 **ATTENTION:** (*) Battery life may vary in accordance with battery brand, programming parameters and environmental conditions of the product is used.

 **ATTENTION:** (**) Battery life may vary in accordance with battery brand, programming parameters and environmental conditions of the product is used.

 **ATTENTION:** miniK10mc is made for only interior usage.

BATTERY REPLACEMENT:

The lock operates using a 3V lithium coin cell CR2450 battery located on back side of device. Remove the battery cover on the back of the lock and replace it with new battery.

TO BE CONSIDERED AFTER BATTERY REPLACEMENT:



- As soon as the batteries are replaced, they should be packaged in a way to prevent short circuit and sent to battery collection centres. Batteries should not be disposed of in the garbage or in nature.
- Waste batteries should not be exposed to moisture, liquids (including water) and heat.
- To prevent risks that may arise from collected waste batteries, they should be temporarily stored in insulated containers or cabinets.

BATTERY FAILURE OVERRIDE: (If the lock installed on to locker)

- Remove the caps from the holes of Red and Green leds, leds insert the pins of the miniK10 Power Adapter into these holes and press.
- When the lock wakes up, enter your password and unlock it.

WHEN USING THE LOCK:

- The battery CR2450 is NOT rechargeable and should NOT be tentatively charged.
- Do not wash the lock.
- Do not allow water to get inside the lock.

WHEN STORAGE THE LOCK:

- Do not open, destroy nor incinerate the battery CR2450.
- Do not crush, pierce, or short "+" and "-" battery terminals with conductive i.e. metal goods, screws.
- Do not directly heat the battery and not throw it into fire.

MAINTENANCE:

- Clean front of lock with a mild damp cloth with detergent if needed.
- Use only Ethanol (Ethyl Alcohol) for disinfecting.
- Do not use any hard or scratching cleanser.
- Do not clean with chemical materials that melt plastic (thinner, acetone, etc.)
- Be careful not to spill water on lock.



ATTENTION!

In case of any failure, inform the vendor in writing of the detailed description of the failure. In case of any intervention in the device, such as attempting to repair the device, the device gets **OUT OF WARRANTY**.

LIMITED WARRANTY:

VMS Elektronik A.S. offers a one year limited warranty all products to be free from manufacturing defects in materials and workmanship. This warranty does not cover the battery, lost combinations or damages caused by improper mounting, improper or unreasonable use.

LIABILITY LIMITS:

This is a limited warranty and is in lieu of all other warranties (including the implied warranties of merchantability and fitness for use) and under no circumstances shall VMS Elektronik A.S. be liable for any incidental or consequential damages or losses.

Thank you

Congratulations for making this eco-friendly choice!

By purchasing a miniK10mc, you will prevent additional batteries going to the landfills over the up to 2 years. This period may be reduced according to battery performance, environmental conditions and frequency of use.



Notes:

.....

.....

.....

.....

.....

.....

.....

.....

.....

.....

.....

.....

.....

.....

.....

.....

.....

LOCKING / UNLOCKING WITH USER CARD

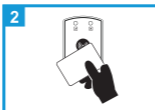



LOCKING / UNLOCKING WITH MASTER CARD





- School / Dormitories
- Hospitals
- Offices
- Staff Lockers
- Rental Lockers
- Security / Defence Lockers
- Gym's / Spa's
- Malls / Stores
- In Home Life
- Hotels / Restaurants
- Mailboxes

 VMS Elektronik San. ve Tic. A.S.
NOSAB Zeytin Cad.14 16220 Nilufer / BURSA / TÜRKİYE
 + 90 (224) 411 10 30
 + 90 (224) 411 10 31



MADE IN TÜRKİYE

somlock.com



somlock and miniK 10mc VMS Elektronik San. ve Tic. A.S.'s trademark.



For Contact

vmselektronik.com
export@vmselektronik.com